

Pitch	Over	Over	Over	Over	Over	Over	Over
6	10	10	30	60	100	150	0.1/1.0
TO	TO	TO	TO	TO	TO	TO	≤
6	10	24	30	60	100	150	±2°
±0.15	±0.20	±0.30	±0.30	±0.50	±0.70	±1.00	±1.30

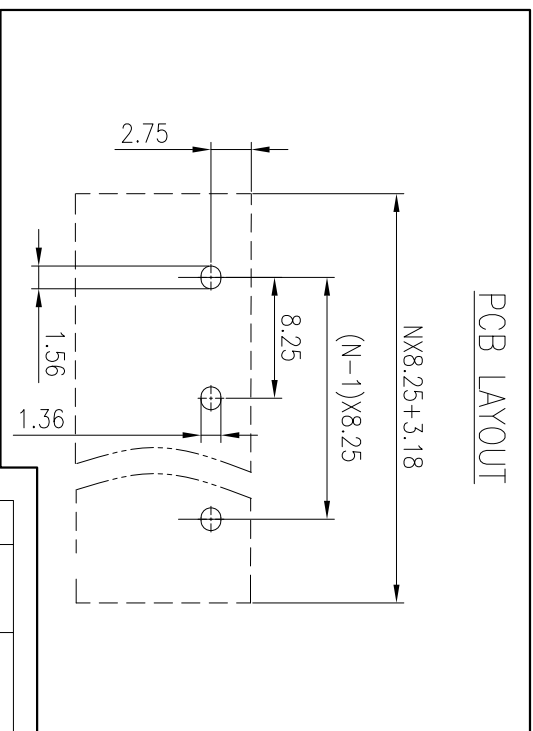
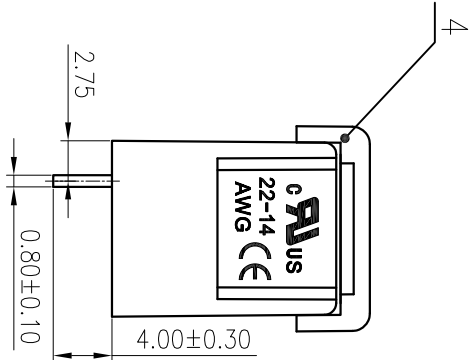
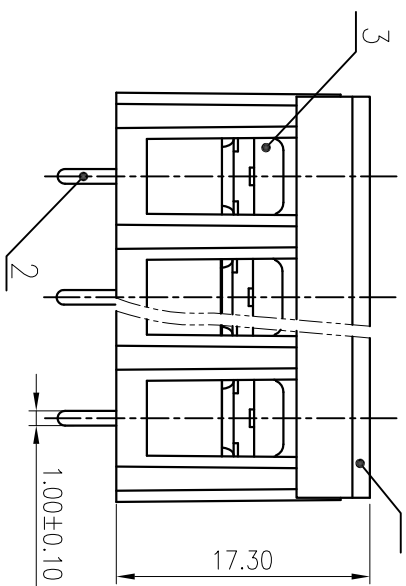
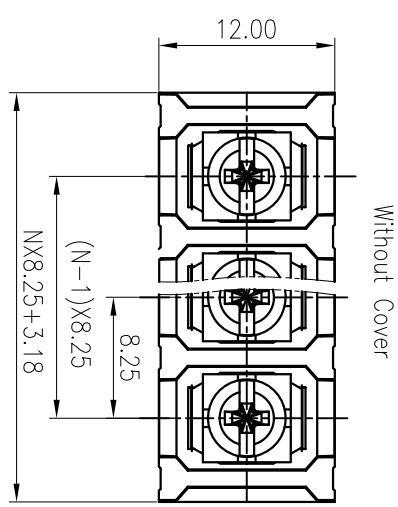

PCB LAYOUT

4	COVER	PC	UL94V-2
3	SCERW	STEEL	NI PLATED
2	PIN HEADER	COPPER ALLOY	Sn PLATED
1	HOUSING	PA66	UL94V-0
ITEM	NAME OF PART	MATERIAL	NOTES
UL 标准/UL Standard:	B	C	D
额定电压/电流/Rated Voltage(V)/Current(A)	300/15	150/15	300/10
EC 标准/IEC Standard:			
过压类别/Overvoltage Category/污染等	III/3	III/2	II/2
额定电压/电流/Rated Voltage(V)/Current(A)	300/24	300/24	600/24
额定脉冲电压(KV)/Rate Impulse Voltage(KV)	5	5	5
额定扭矩/Torque Tightening(N·m/Lb·in)	M3, 0.5/4.43		
线径范围/Wire Range(AWG)	22~14AWG		
间距/Pitch(mm)/线数范围/Poles	8.25/N=02~24P		
剥线长度/Stripping Length(mm)	8		
使用温度范围/Operating temperature(°C)	-40~+105		
符合RoHS环保要求/Conform to RoHS	Yes		

SURFACE: /

MATERIAL: /

MAT NO.: /

STATUS: /

APPD: /

CHKD: /

DRFT: Zhangju 2020.05.26

宁波高松电子有限公司
NINGBO DEGSON ELECTRICAL CO., LTD

NAME: DG38S-B-XXP-1Y-00A(H)

DRAWING NO.: DG38S-C02

TYPE: CUSTOMER DRAWING

SCALE: 2:1 SHEET 1/1

REV	ECN	DESCRIPTION	DRFT	DATE