

REVISION RECORD			
REV	ECN	DESCRIPTION	DATE

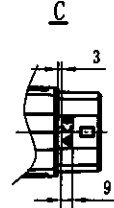

Wiring diagram

POWER SUPPLY ELECTRIC VEHICLE

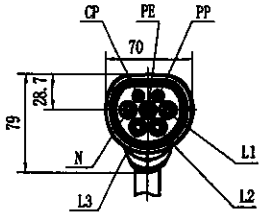
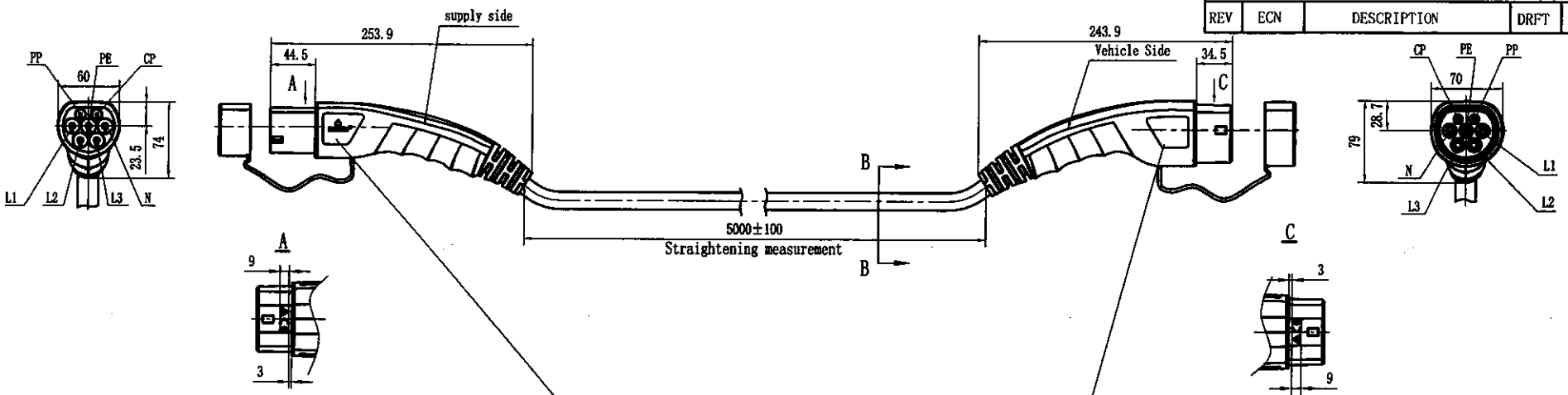
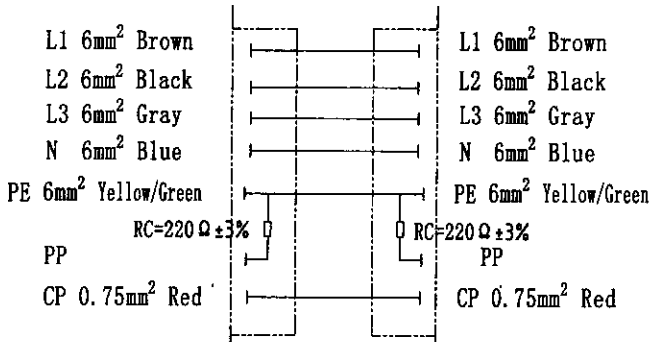

Laser Printing Front Note:

 Laser Printing Back Note(Arial) :
 MEAC-T-032A-P1-03-5.0M-30AH
 32A 440V AC
 IEC 62196-2:2016
 IP54
 201xxxx-xxxx

Laser Printing Front Note(Arial) :
 MEAC-T-032A-V1-03-5.0M-30AH
 32A 440V AC
 IEC 62196-2:2016
 IP54
 201xxxx-xxxx
 Laser Printing Back Note:

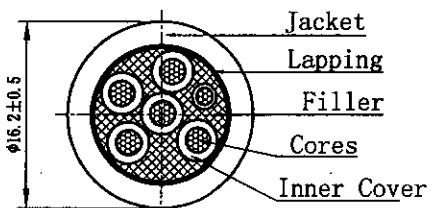

SEC B-B

Technical parameters

Rated voltage	440V AC
Rated current	32A
Temperature range	-30℃~+50℃
Insulate resistance	>5MΩ, 500V DC 1Min
Withstand voltage	L、N AND PE, 2500V AC 1Min
	L AND N, 2500V AC 1Min
Ingress protection	IP54
The insertion/pullout times	10000 TIMES
Insertion/pullout force	<100N
Standard	IEC 62196-2:2016

Customer Drawing

NOTES:

1. Cable: EN50620-2017 EV 5*6mm²+1*0.75mm² Black
2. RoHS Compliance

Size Measure Range	.XX	.X
≤6	±0.05	±0.10
6~30	±0.10	±0.20
30~120	±0.15	±0.30
120~400	±0.20	±0.50
400~1000	±0.30	±0.80
1000~2000	±0.50	±1.20
Angle Measure Range	.XX	.X
	±0.5°	±1.0°

PART NO.:	宁波高松电子有限公司 NINGBO DEGSON ELECTRICAL CO., LTD		
APPD:	NAME: EV ELECTRIC VEHICLE AND EV POWER SUPPLY (32A three-phase)		
CHKD:	MEAC-T-032A-V1P1-03-5.0M-30AH		
DRFT:	TITLE: Customer Drawing		REV: D0-1
	DRAWING NO.:	SHEET: 1/1	
	DO NOT SCALE DRAWING		SCALE: 1:6

